



Specialists in high  
quality concrete products

**SLURRY**

**CHANNELS**

**& SLATS.**

[www.cwpconcrete.com](http://www.cwpconcrete.com)

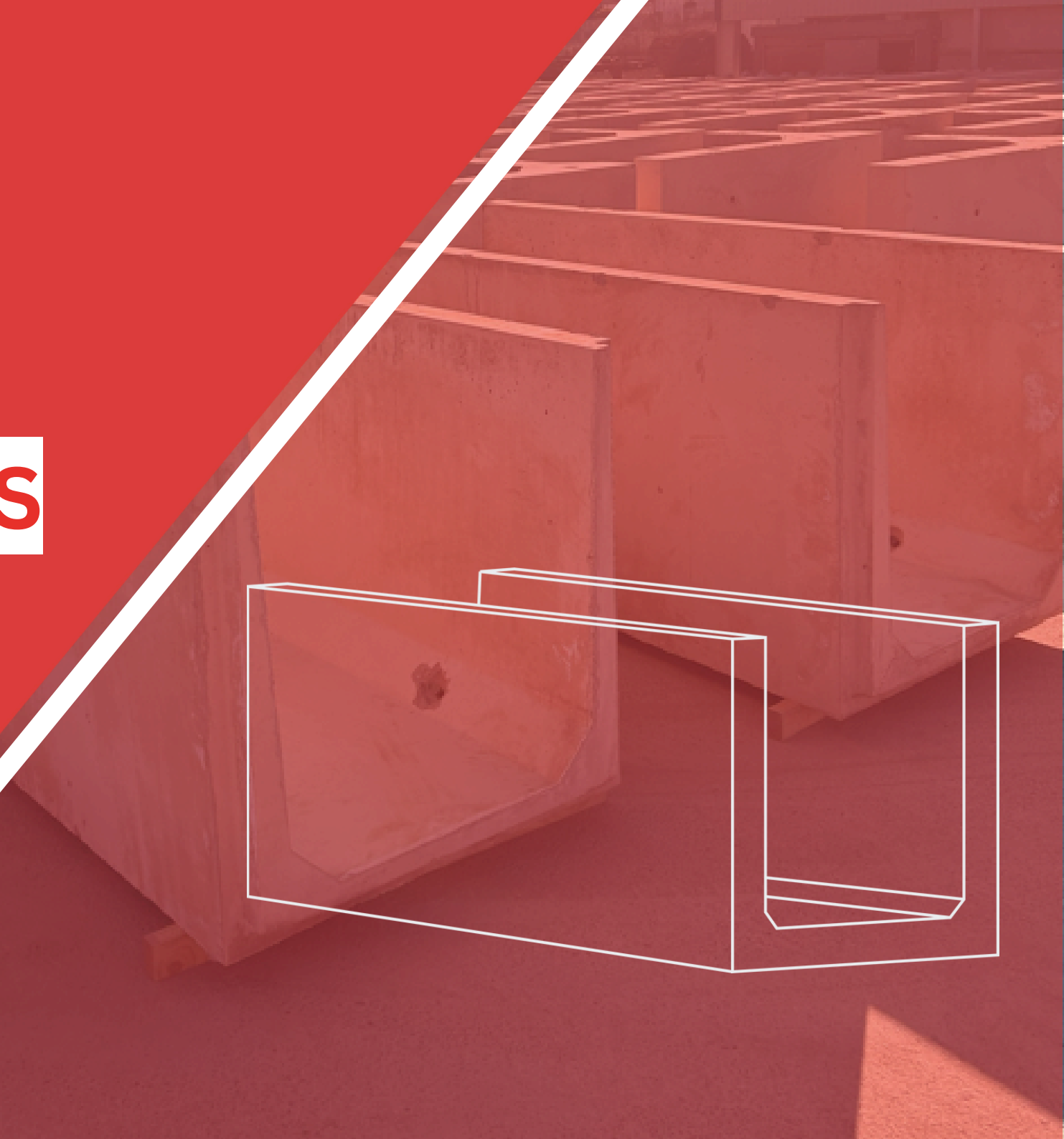

**Our concrete slurry channels are designed to handle the everyday demands of modern farming.**

Built from reinforced concrete for exceptional strength and longevity, they provide an efficient way to manage slurry and runoff, keeping your yard clean and operational.

### Product details

- 1m wide × 1m high × 2.4m long
- Built-in lifting pins for safe, easy installation (clutch lifters supplied)
- Available as open-ended units or with a 200mm end cap

### Where our slurry channels are used

Our concrete channels are ideal for:

- Main collection systems in cattle yards
- Managing runoff around feed and handling areas
- Waste control in milking parlour approaches
- Collecting slurry in covered livestock housing
- Linking storage lagoons and tanks
- Temporary diversions during maintenance

### Complete your system

Pair your slurry channels with our concrete slats, available in:

- Standard slats – for general use
- Diagonal slats – for improved grip
- Heavy-duty slats – suitable for machinery crossings

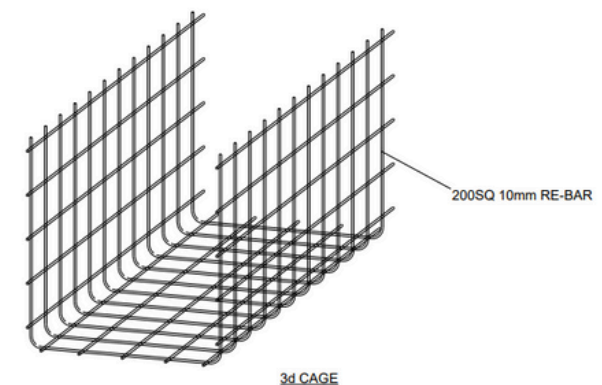
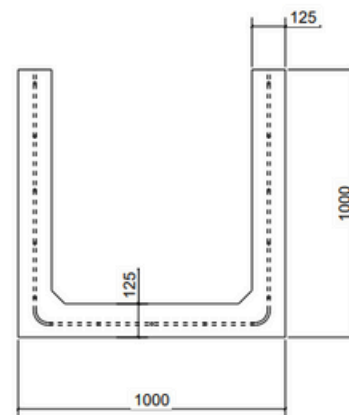
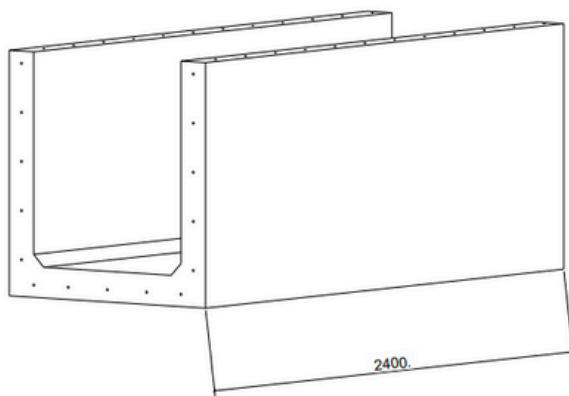

## SOLID LID SLAT

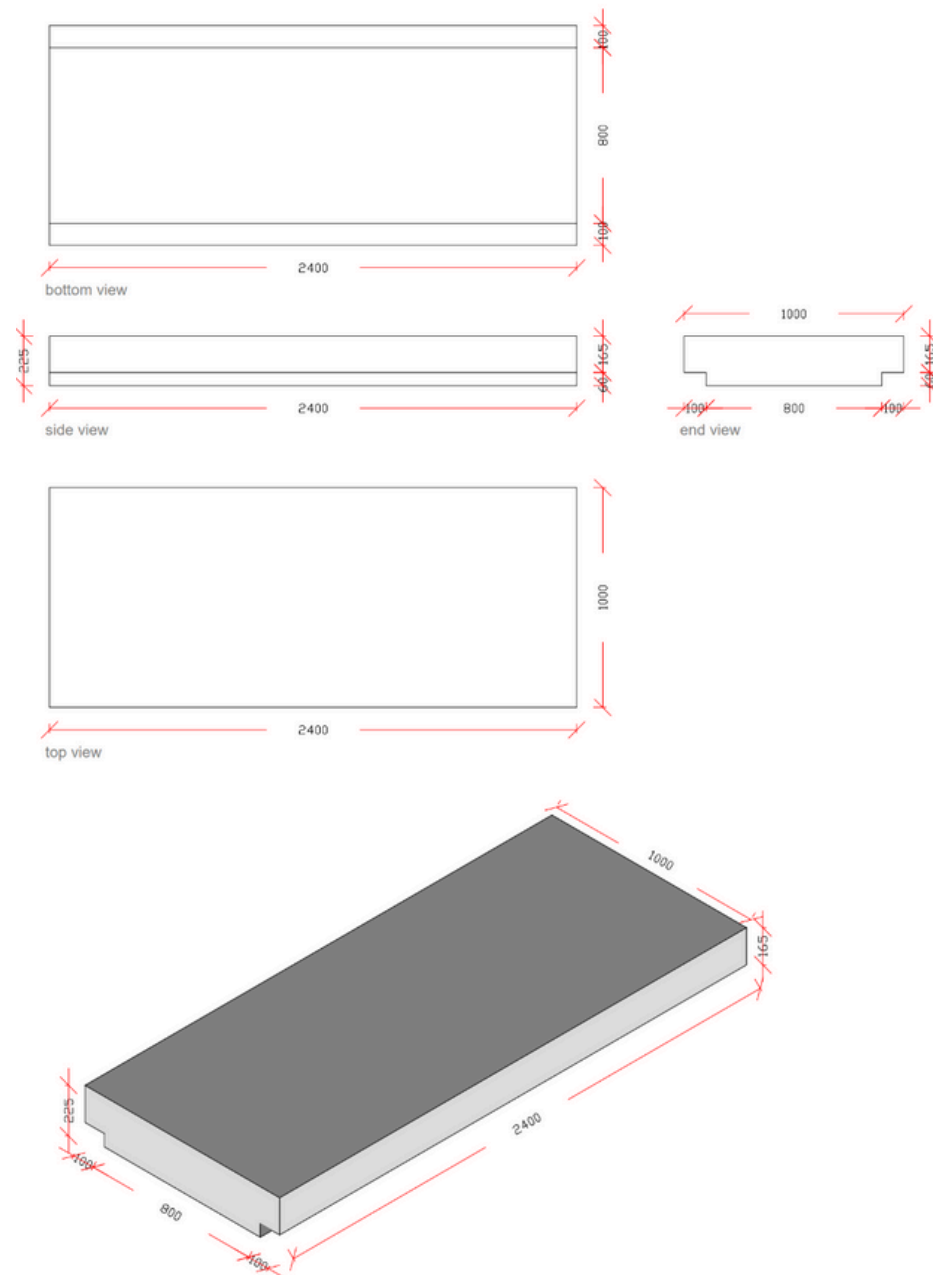

## DIAGONAL SLAT

